

Stop

200-2 SCOPE-MOBILE

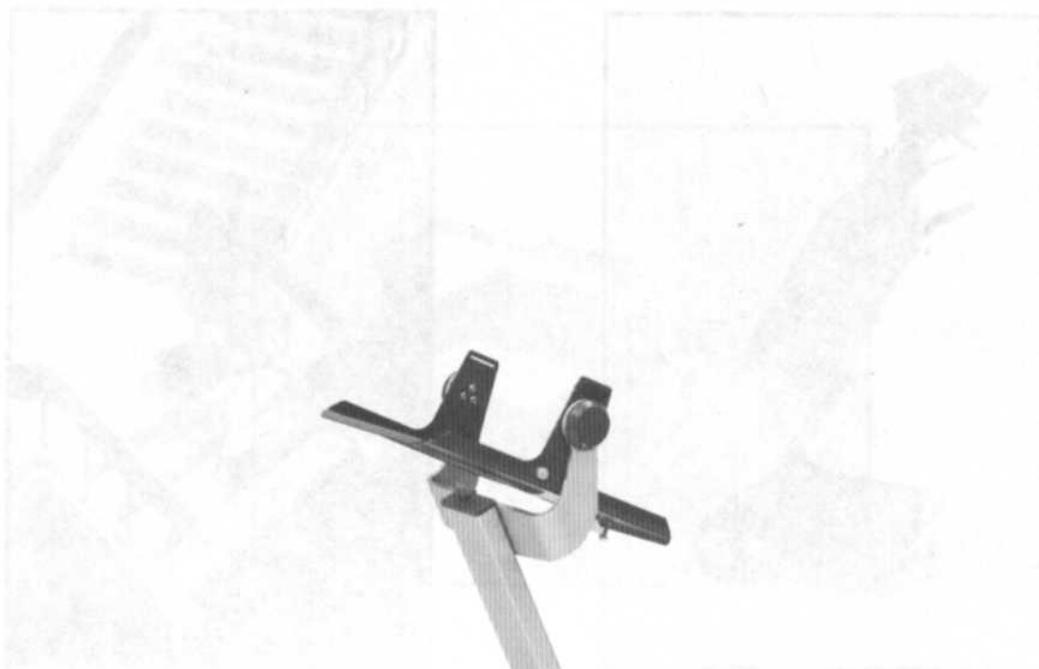

DATA SHEET

NO. 062-0871-00

DATE MAY 1972 (R)



COPYRIGHT © 1969
TEKTRONIX INC.
ALL RIGHTS RESERVED



This specially designed scope-mobile can be utilized with a full complement of camera equipment. But when using it in this situation, it is advisable that the tray be in the latch position as shown. This stabilizes the instrument, insuring motionless position when the camera is being used to capture a specific waveform.

When transporting the scope-mobile, place the tray in the latch position as shown. It may be easily moved up or down stairs and from one area to another.

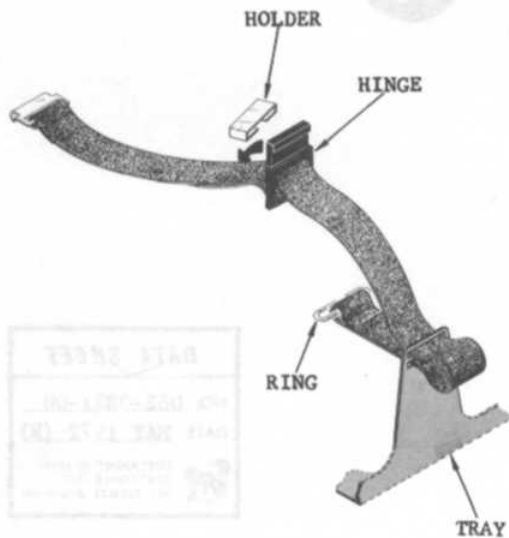

To attach strap assembly to the tray, thread plain end through double slotted side as shown. Make the strap configuration similar to the diagram. When you have the approximate length to secure the instrument to the scope-mobile, insert the ring through the loop in the strap and cinch up tight. Slip the holder onto the strap and slide to the approximate position shown in the diagram.

Hook the free end through the single slot in the tray. Press the black hinge flat against the strap atop the instrument and position holder in slot of hinge.

If instrument is not securely strapped to the tray, slip back the holder releasing pressure and take up slack at the double slotted side of the tray.

BRAKE ADJUSTMENT

Index No.	Technical Part No.	Serial/Model No.	Disc	Y	Z	W	Part No.
-----------	--------------------	------------------	------	---	---	---	----------

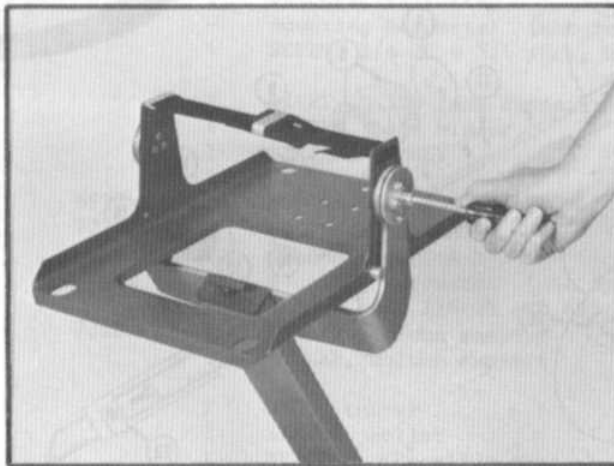
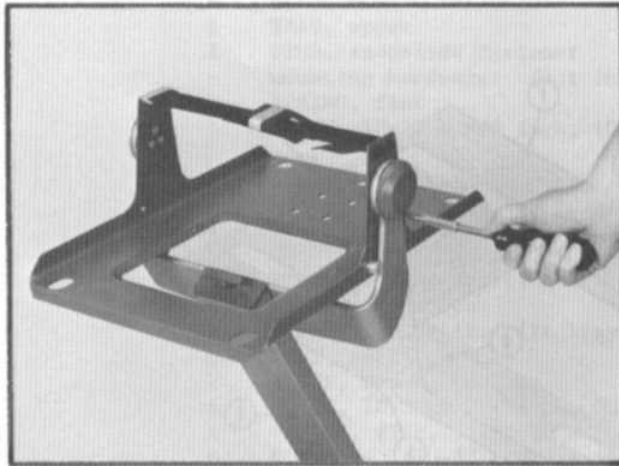

Due to the convenient brake system, the tray can be stabilized in many positions. Adjustment of the brakes for more or less tension can be done quickly.

With a No. 1 phillips head screwdriver, remove the securing screw and brake cover, exposing the adjusting nuts. Next, take a 3/8 inch nut driver and adjust the brake for the desired tension. This procedure should be followed for both brakes.

I FIG. 1 200-2 SCOPE-MOBILE

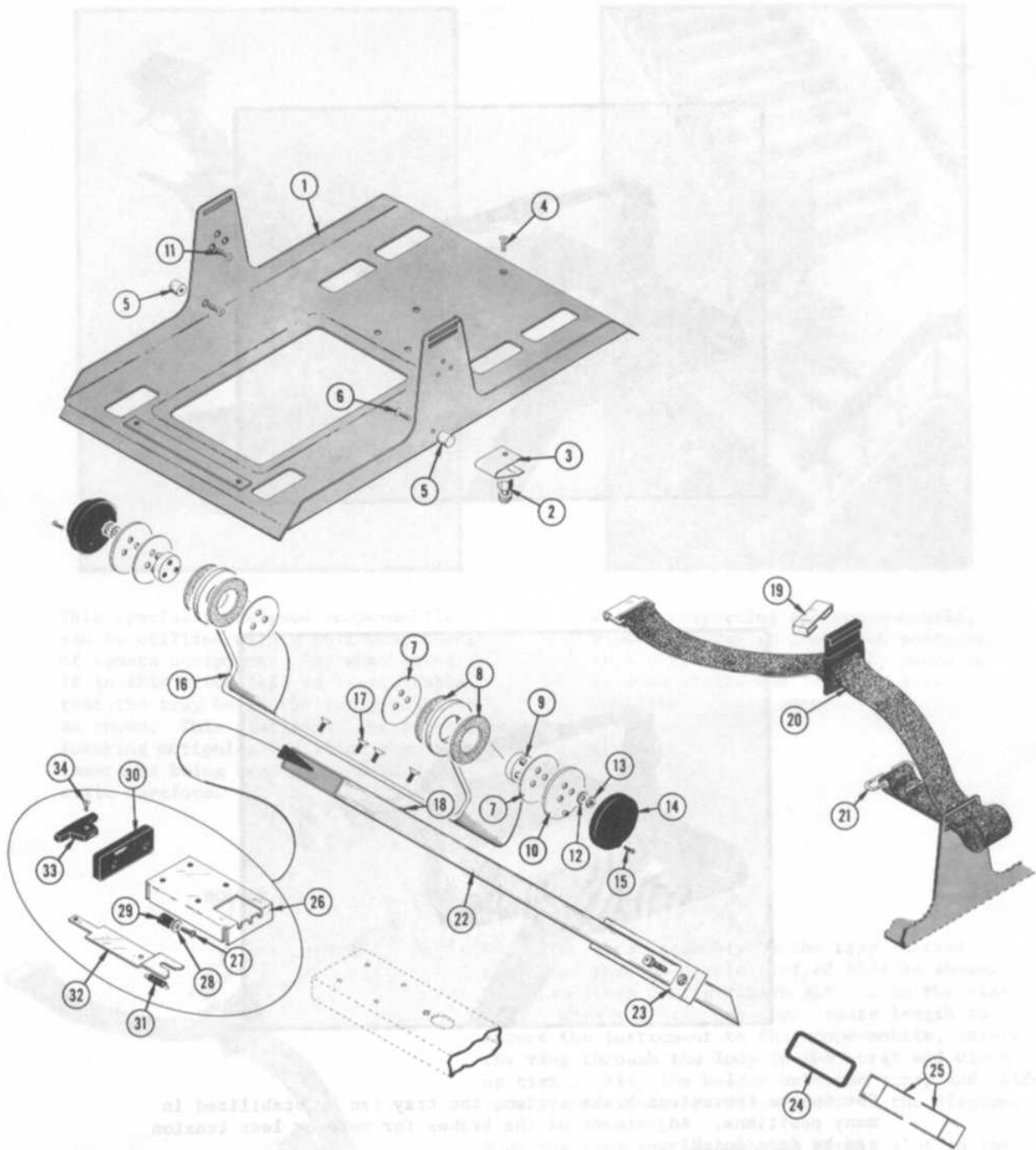
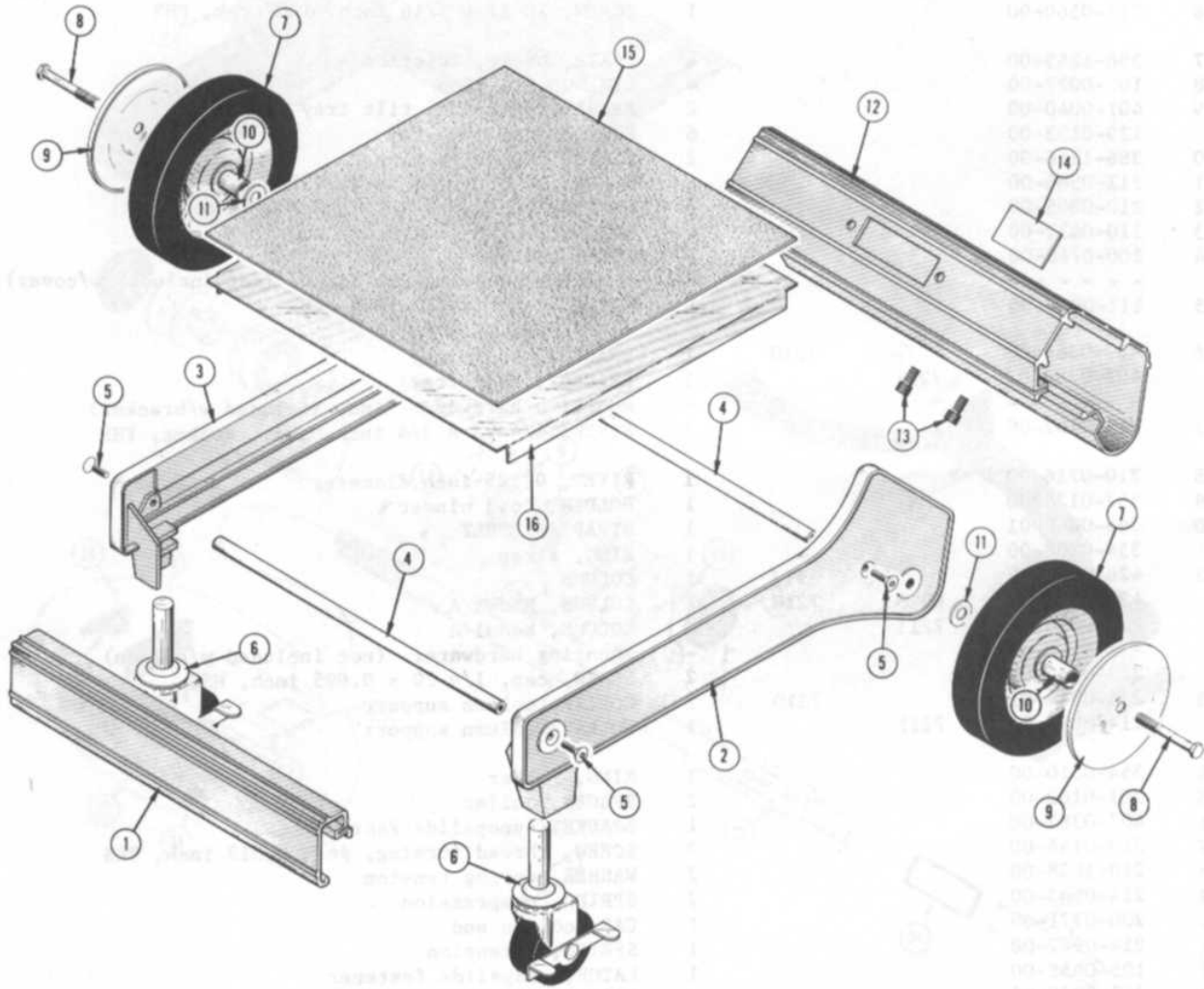

FIG. 1 200-2 SCOPE-MOBILE

Fig. & Index No.	Tektronix Part No.	Serial/Model No.		Q † y	1	2	3	4	5	Description
		Eff	Disc							
1-	- - - - -			-						200-2 SCOPE-MOBILE
	- - - - -			-						scope-mobile includes:
-1	436-0076-00			1						TRAY, upper
-2	355-0119-00			1						STUD, snapslide fastener
	- - - - -			-						mounting hardware: (not included w/stud)
-3	214-0940-00			1						SPRING, flat
-4	212-0506-00			1						SCREW, 10-32 x 3/8 inch, 100° csk, FHS
	- - - - -			-						mounting hardware for each: (not included w/stop)
-5	105-0060-00			2						STOP, tilt tray
-6	212-0560-00			1						SCREW, 10-32 x 5/16 inch, 100° csk, FHS
	- - - - -			-						mounting hardware for each: (not included w/stop)
-7	386-1265-00			4						PLATE, brake, friction
-8	107-0027-00			4						LINING, friction
-9	401-0040-00			2						BEARING, plastic, tilt tray
	129-0133-00			6						POST, metal
-10	386-1266-00			2						PLATE, brake, backing
-11	212-0586-00			6						SCREW, 10-32 x 7/8 inch, OHS
-12	210-0805-00			6						WASHER, flat, 0.204 ID x 0.438 inch OD
-13	210-0472-00			6						NUT, hex., 10-32 x 0.375 inch
-14	200-0768-00			2						COVER, brake
	- - - - -			-						mounting hardware for each: (not included w/cover)
-15	211-0007-00			1						SCREW, 4-40 x 3/16 inch, PHS
	- - - - -			-						mounting hardware for each: (not included w/cover)
-16	407-0384-00		7210	1						BRACKET, tilt tray
	407-0384-02	7211		1						BRACKET, tilt tray
	- - - - -			-						mounting hardware: (not included w/bracket)
-17	213-0162-00			4						SCREW, 1/4-20 x 3/4 inch, hex., socket, FHS
	- - - - -			-						mounting hardware: (not included w/bracket)
-18	210-0716-00			1						RIVET, 0.125 inch diameter
-19	352-0128-00			1						HOLDER, load binder
-20	346-0049-01			1						STRAP ASSEMBLY
-21	354-0308-00			1						RING, strap
-22	426-0383-00		6917	1						COLUMN
	426-0383-02	6918	7210	1						COLUMN, Model A
	426-0383-04	7211		1						COLUMN, Model A
	- - - - -			-						mounting hardware: (not included w/column)
	213-0163-00			2						SCREW, cap, 1/4-20 x 0.625 inch, HSS
-23	214-0944-01		7210	1						COLLAR, column support
	214-0944-02	7211		1						COLLAR, column support
	- - - - -			-						mounting hardware: (not included w/column)
-24	354-0310-00			1						RING, rubber
-25	361-0162-00			2						SPACER, collar
-26	407-0382-00			1						BRACKET, snapslide fastener
-27	213-0146-00			2						SCREW, thread forming, #6 x 0.313 inch, PHS
-28	210-1038-00			2						WASHER, spring tension
-29	214-0943-00			2						SPRING, compression
-30	200-0771-00			1						CAP, column end
-31	214-0942-00			1						SPRING, extension
-32	105-0058-00			1						LATCH, snapslide fastener
-33	367-0078-00			1						HANDLE
	- - - - -			-						mounting hardware: (not included w/handle)
-34	211-0541-00			1						SCREW, 6-32 x 1/4 inch, 100° csk, FHS

FIG. 2 200-2 SCOPE-MOBILE



200-2
200-2

FIG. 2 200-2 SCOPE-MOBILE

Fig. & Index No.	Tektronix Part No.	Serial/Model No.		Q f y	Description
		Eff	Disc		
2-	- - - - -			-	200-2 SCOPE-MOBILE
	- - - - -			-	scope-mobile includes:
-1	426-0381-00		6917	1	FRAME, base, front
-2	426-0379-01		6917	1	FRAME, base, right
	426-0379-02	6918		1	FRAME, base, right, Model A
	- - - - -			-	frame includes:
	401-0063-00			2	SOCKET, caster (not shown)
-3	426-0380-01		6917	1	FRAME, base, left
	426-0380-02	6918		1	FRAME, base, left, Model A
	- - - - -			-	frame includes:
	401-0063-00			2	SOCKET, caster (not shown)
-4	384-0677-00			2	ROD, spacing
	- - - - -			-	mounting hardware for each: (not included w/rod)
-5	213-0165-00			2	SCREW, 1/4-20 x 1 inch, hex., socket, FHS
-6	348-0121-00		6917	2	FOOT, cabinet
	401-0062-00	6918		2	CASTER, w/brake, Model A
-7	401-0039-00			2	WHEEL
	- - - - -			-	mounting hardware for each: (not included w/wheel)
-8	213-0160-00			1	SCREW, cap, 3/8-15 x 2 inches, HSS
-9	200-0773-00			1	HUB CAP, wheel
-10	401-0041-00			1	BUSHING
-11	210-1044-00			1	WASHER, flat, 0.375 ID, x 0.750 inch OD
-12	426-0382-00		6917	1	FRAME, base, rear
	426-0382-01	6918		1	FRAME, base, rear, Model A
-13	213-0163-00		6917	2	SCREW, cap, 1/4-20 x 5/8 inch, HSS
	213-0224-00	6918		2	SCREW, cap, 1 1/4 inches, HSS, Model A
	361-0268-00	X6918		2	SPACER, sleeve (not shown)
-14	334-1125-00		6917	1	PLATE, identification
	334-1125-02	6918		1	PLATE, identification, Model A
-15	107-0026-00			1	SHEET, linoleum
-16	436-0074-00			1	TRAY, lower